

# Your Local Store for **AGRICULTURE** Parts, Tools, & Shop Supplies

REGINA: (306) 525-2551  
YORKTON: (306) 783-6515  
ESTEVAN: (306) 634-3664  
WEYBURN: (306) 842-4676  
MAINLINE FLEET: (306) 721-7711



## Mobile Parts Washer

This Mobile Parts Washer won't last long! Non-toxic, self-cleaning, with a flexible nozzle and brush with no hazardous waste. Features a 15-gallon tank with a load capacity of 400lbs!



CRC14743



## Rodents Away

Winter is coming, and uninvited guests are looking for warm places to nest! Rodents Away is an odorless, all-natural repellent that stops mice in their tracks without the use of poisons, glue-traps, or any other mechanical devices that can cause injury or harm. Each bag contains six 40g packets.

ROD19471

**PARTS**

**AUTOBODY SUPPLY**

**INDUSTRIAL**

**REGINA**

**YORKTON**

**WEYBURN**

**ESTEVAN**



# WIX FILTERS



**For all of your filtration needs!**

## Steel Tray Wheel Barrow

Transport dirt, mulch, gravel, tools and other materials easily with the True Temper contractor wheelbarrow. It has a 6 cu. ft. tray with a maximum capacity of 270lb.



**GAR 01044**

Clearance item - Limited Quantities while supplies last

## 17" Contractors Dust Pan

This contractor-grade dustpan is made of heavy-duty aluminum, so it's sturdy yet light, and easy to use and store. Rubber coated handle is 9" long. Heavy-duty aluminum dustpan is 17" wide. Grooved edges for broom and brush cleaning.



**GAR 84630**

## Brooms

### Heavy Duty Corn Broom

Indoor/outdoor use.



**GAR 84578**

### Maroon Durastran Broom

- Wet/dry sweeping
- 3" polystyrene bristles
- For concrete and asphalt
- 24" long with handle



**PBP 92-262**

### Indoor/ Outdoor Push Broom

- 24" Polypropylene push broom head with handle
- 3" acid-resistant bristles
- Wet/dry sweeping



**PBP 92-232**

### Tampico & Steel Broom

- 3" bristles
- Center row of steel bristles
- Acid-resistant
- 24" long, comes with handle



**PBP 92-282**

## 30" Foam Double Edge Squeegee

4" twin rubber blades. Handle sold separately.

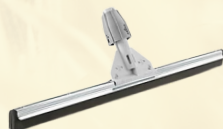

**PBP 83-304 | Squeegee**  
**PBP 85-978 | Handle**

## Floor Scraper

Floor scraper, with flexible and replaceable steel blade. 22" wide, wood handle.



**GAR GPFS22**

## Sidewalk Scraper

Industrial-grade sidewalk scraper, forged and tempered steel blade, high-quality varnished hardwood long handle.



**GAR YFSW9**

## Grain Shovel

Supplied with tubular fiberglass handles for light weight and strength. Cushion grip on both 28" and 48" for comfort. Aluminum blades are riveted to handle. Ribbed blade to add extra strength.



G. HJUKSTROM LTD.

**HJU 511172**

## Round Point Shovel

Equipped with a forward-turned footstep to provide you with better comfort. Designed for residential use, this tool is ideal for people looking for excellent quality/price.



**GAR 00197**

## Square Point Shovel

The square point shovel is ideal for scooping and moving dirt, gravel and other landscaping material. Solid ash handle is stained to help prevent chipping and water damage. Blade width 10.5".

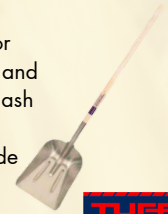

TUFF GRADE

**ADC TGHS2L**

## Ergonomic Snow Shovel

- Allows better posture
- Large and deep blade
- 53.5" X 18"



**GAR 78521**

## Snow Pusher

- 24" aluminum handle



**GAR 78522**

## Ergonomic Snow Pusher

- Lightweight
- Allows better posture
- Meant for large surfaces



**GAR 78523**

## 36" Snow Pusher

- Lightweight
- Large blade
- Improved posture



**GAR 80773**



**PARTS**

**AUTOBODY SUPPLY**

**INDUSTRIAL**

**REGINA**

**YORKTON**

**WEYBURN**

**ESTEVAN**



# Quality Rotating Electrical In Stock!



## Nitrile Coated Gloves

- 13 Gauge polyester
- Shell colour: grey
- Palm colour: black
- Improved grip and dexterity

ADC TGG-200-08 | M  
ADC TGG-200-09 | L  
ADC TGG-200-10 | XL



## Red Baron Gloves

- Heavy sherpa lining
- Full-grain cowhide leather
- Cotton drill back
- Shirred elastic wrist
- Slip-on style safety cuff

WAT 94002 | S-3XL



## Flex Time Gloves

- 3M Thinsulate™ C40 lining
- Dryhide™ water-resistant full-grain goatskin leather palm
- Hooded fingertips, thumb reinforcement, spandex back
- Snug-fitting elastic wrist with secure Velcro® closure

WAT 9005W | S-2XL



## Safety Glasses

Soft adjustable nosepiece to help reduce slippage. Incorporates dual-material temples to provide cushioned comfort plus enhanced style and features. The proprietary 3M™ Pressure Diffusion Temple Technology that helps diffuse pressure over the ear.



MMM SF401AF-CA



## Anti-Fog CCS Protective Eyewear

Foam Gasket helps limit eye exposure to nuisance dust and other particles while providing additional cushioning. The anti-fog lens coating and removable foam lined gasket with airflow vents. Polycarbonate lenses absorb 99.9% UVA and UVB. Meets the requirements of CSA.



MMM 11872



## Industrial Grade Duct Tape

Composed of a waterproof polyethylene film over cloth scrim backing with a rubber adhesive used for demanding applications. Offers high tack, conformability, strength and easy tear. The individual roll wrap preserves integrity of the roll for less waste. Features good moisture resistance and has good tensile strength.



MMM 06975



## Tesa 51036 PET Cloth Wire Harness Tape

Black 3/4" x 25M. Tesa PET cloth wire harness tape with an advanced acrylic adhesive.

- Flag resistant
- High temperature resistance 150°C/3000h
- Excellent abrasion, chemical and fluid resistant
- Large 19mm x 25M rolls

LWR 51036



## PRO-LINE XT

Fast drying and highly visible. Wear, weather, and chemical resistant, this paint marker is meant for rough, rusty, and dirty surfaces.

MKL 097250 | White  
MKL 097251 | Yellow  
MKL 097252 | Red  
MKL 097253 | Black  
MKL 097254 | Blue



## SILVER-STREAK Metal Marker

Ideal when highly-visible, torch-resistant marks are required during metal layout and fabrication work. The unique reflective lead is more visible through a welder's filter plate and will not rub, burn or blow off like soapstone. Marks on all metal surfaces including oily or wet.

MKL 096107 | Holder with 6 Refills  
MKL 096007 | 6 Refills ONLY



## Fast Orange Hand Cleaner

Pure, orange scented natural citrus power does the cleaning. Fortified with aloe, lanolin, glycerin, and other skin conditioners.

PER 23218 | 3.8L Smooth  
PER 25219 | 3.8L Pumice



## Fast Orange Hand Wipes

Removes the toughest grease, tar, grime, ink, paints, sealants, adhesives and other difficult soils. 72 wipes per container.

PER 25051



## Shop Towels

Strong shop towels that expertly absorb oil and grease, even when they're wet! 55 sheets per roll.

KIM 75120



PARTS

AUTOBODY SUPPLY

INDUSTRIAL

REGINA

YORKTON

WEYBURN

ESTEVAN



The safest, most durable, and efficient industrial hoses, couplings, accessories, and equipment.



### Box of Rags

In a 20lb box or bale. Great for economical clean ups in the shop or home. Absorbs greases, oils, and more.

RBW 24020 | Box of Fleecy Rags  
RBW 24020BALE | Bale of Fleecy Rags  
RBW 60020 | Box of White Ganzies Rags



### Garbage Bags

Multiple sizes available to suit all your needs.

ADC TGGB2636XSB | 26" x 36" | 125/case  
ADC TGGB3550XSB | 35" x 50" | 100/case  
ADC TGGB4248XSB | 42" x 48" | 100/case  
ADC TGGB5050XSB | 50" x 50" | 100/case



### Qualisorb

Qualisorb® is the most efficient way to soak up liquid spills wherever you need to absorb unwanted liquid.



QUA 628

### 3 Piece Funnel Assortment

Made of tough, high-density polyethylene for dispensing petroleum-based fluids. May be used with substances such as oil, radiator fluid or fuel additives. Includes: 1 gray 1/2-pint, 1 charcoal 1-pint, and 1 black 2-quart.



BLI 05068MI

BL+TZ

### 7 Quart Catch All Pan

- Built-in raised rim handles
- Unique oversized pouring spout
- 7-quart capacity with drain scale that helps track oil usage
- Lightweight and stackable
- Multi-purpose use



BLI OP-1

BL+TZ

### Giant Quick Funnel

Has an easy grip guard that makes pouring safe and easy. Includes a snap-in screen. Applications include fuel and oil for marine use, tractors, and trucks. Innovative and sturdy design.



BLI 10705

BL+TZ

### Fuel Filter Funnel

With a 5 gal/minute flow rate this fuel filter removes water, dirt and debris. Filters gasoline, heating oil, and kerosene, as well as 2 cycle mixed gas.



BLI F8C

BL+TZ

### Cable Ties

Cold weather black cable ties, 100pc each.



PIC 7295-36 | 7.5"  
PIC 7296-36 | 11"  
PIC 7297-36 | 14"  
PIC 7298-36 | 14" (120lbs)



### Tarps

Waterproof and resistant to chemicals, tearing and mildew. Weave: 10 x 10, GSM: 135, Material: High density polyethylene. Aluminum grommets every 3'. Polyethylene Rope Reinforced Hems.

ADC TARP-1015-BLUE | 10' x 15'  
ADC TARP-1520-BLUE | 15' x 20'  
ADC TARP-2030-HDB | 20' x 30'



### Cold Weather Tarp Straps

Tie down strap made of rubber. Injection molded EPDM (no imperfections). 2-1/2 times safe stretch, non-cracking. Meets DOT safe working load limit. Operational to -40°C. Stamped with 50 lb SWL as required by DOT.

HJU SH09CO | 9"  
HJU SH15CO | 15"  
HJU SH20CO | 20"  
HJU SH30CO | 30"



### Ratchet Straps

- Allows loads to be secured with maximum holding force and includes steel coated S-Hooks.
- Breaking Strength: 3000 lbs
- Working Load Limit: 1000 lbs

ADC RS-102 | 1" x 16'  
ADC RS-103 | 1" x 20'



### Ratchet Strap 2" x 27'

- Double J-hooks
- Heavy-Duty ratchet tie-down
- Yellow nylon woven straps
- Breaking Strength: 11 000 lbs
- Working Load Limit: 5000 lbs

ADC RS-227CE



PARTS

AUTOBODY SUPPLY

INDUSTRIAL

REGINA

YORKTON

WEYBURN

ESTEVAN



**Gates Automotive V-Belts are designed to wear evenly to prevent belt slippage and to extend service life of the most demanding engine drives.**



### Anaerobic Gasket Maker & Sealant

Flexible, gasketing material for use on rigid machined flanges with less than .015" gap. OEM approved use where OE specify "anaerobic" gasket (cures in the absence of air). Withstands temperatures to 300°F (149°C). Eliminates preformed, pre-cut, paper, rubber and cork gaskets. Flexes with flanges that move in service.

PER 51550 FLANGE SEALANT | 50ml  
PER 51580 FLANGE SEALANT | 300ml  
PER 51845 GASKET MAKER | 300ml



### Permatex Threadlocker

OEM specified. A permanent, high strength product applied to fasteners 3/8" to 1" (10mm to 25mm) in size before assembly. Designed for securing parts that must withstand heavy shock, vibration, or extreme chemical or environmental conditions. Localized heating and hand tools are required to separate parts. Conforms to ASTM D5363 AN0331 (Mil-S-46163A, Type II, Grade O).

PER 24240 | Blue | 36ml  
PER 26240 | Red | 36ml



### Permatex Threadlocker Gel Twist

OEM specified. Gel formula provides "liquid-reliability" without drips, globs, mess or waste. High strength threadlocker for heavy-duty applications 3/8 inch to 1 inch (10mm to 25mm). Adds 3,000 PSI holding power on slip and press fit assemblies. Replaces set screws and snap rings. Locks against vibration loosening. Conforms to ASTM D5363 AN0221 (Mil-S-46163A, Type I, Grade K).

PER 24215 | Blue | 36ml  
PER 27115 | Red | 36ml



### IronTite

Stop leaks in coolant systems, seal minor cracks in cylinder heads & blocks. Used by professionals for over 35 years.

IRT 913216 | All Weather Seal  
IRT 911216 | Thoro-Flush



### Super Clean Cleaner-Degreaser

Works on contact - quickly removes grime, oil, wax, dirt and tar. Industrial strength with biodegradable detergents. Easily tackles household, automotive and shop tasks.

SCL 101780 | 32oz.  
SCL 101723 | 3.75L  
SCL 101724 | 9.5L  
SCL 100725 | 18.9L  
SCL 100727 | 209L



### Citrol Degreaser

Rapidly penetrates and removes a wide range of soils, dirt, and inks. Contains no petroleum or chlorofluorocarbon-type solvents. Smells pleasantly of citrus!

NSI 266



### Glass Kleen

Ideal for auto, marine, fleet and home use. Cleans windows, mirrors, formica and porcelain. Specially formulated for body shops and industrial use.

KLF 886 | 22oz.



### Trans Tune Treatment

Cleans harmful fluid residue that causes rough system operation and erratic shifting. For use in hydraulic fluid, automatic transmissions, and power steering systems.

SFC TT16



### Non-Chlorinated Power Jet

The newest non-chlorinated brake parts cleaner for Canada from the #1 brand. Specially formulated to remove even the strongest contaminants from brake linings and pads.

CRC 1752253 | 411g



### Belt Dressing

Eliminates squeaks and prolongs belt life. For use on all types of belts, such as serpentine, flat and v-type belts. Prevents slippage and glazing and removes oil, grease and glaze.

CRC 75350 | 10oz.



### Freeze-Off

Immediately drops the temperature of the area in direct contact with the spray. The freezing effect cracks rusted surfaces, allowing it to reach deeper & work more effectively than other penetrants.

CRC 75222 | 326g



### Deep Creep

Works fast to break metal surface tension. Frees stubborn parts from rust & corrosion. Use to oil bushings, chains, gears, hinges, rollers & slides.

SFC DC14



**PARTS**

**AUTOBODY SUPPLY**

**INDUSTRIAL**

**REGINA**

**YORKTON**

**WEYBURN**

**ESTEVAN**



## Knock'er Loose

An industrial strength, low viscosity super penetrant designed to quickly loosen and free seized, bound or frozen fasteners. Quickly permeates rust, scale, gum, grease and corrosion.

CRC 73020 | 16oz.



## Aero-Kroil

Wherever there is corrosion either due to heat, salt water, chemical action, or weathering- Kroil will loosen metal joints saving labor, equipment and temper. Dissolves gum, dried grease and oil, removes rust and carbon deposits without attacking the metal.

KAN AEROKROIL-100Z | 10oz.  
KAN KROIL-GAL | 1 Gallon



## MAG1 Lubricants



**SAE 15W-40 Engine Oil**  
PMO MAG62631 | 1 Gallon  
PMO MAG67980 | 5 Gallons  
PMO MAG67983 | 55 Gallons



**SAE 5W-40 Full Synthetic**  
PMO MAG62627 | 1 Gallon  
PMO MAG68036 | 5 Gallons  
PMO MAG68037 | 55 Gallons



**Hydraulic Fluid**  
PMO MAG65847 | ISO AW22 5 Gallons  
PMO MAG00325 | ISO AW32 5 Gallons



## Air Induction Spray

Cleans & lubricates critical upper engine areas where fuel cleaners can't reach.

SFC SS14 | 12oz.



## Cutting Oil

Cutting Oil is a superior thread cutting lubricant for use on all types of metals, including brass, copper and aluminum.

CRC 75500 | 16oz.



## Dry Graphite Lubricant

Ideal where a dry lubricant is required or where petroleum products must be avoided. Resists dirt, dust and oil build-up. Wide effective temperature range up to 850°F constant.

CRC 75101 | 16oz.



## Tool Box Buddy

- Long lasting, waterproof lubricant
- Super slick - allows air tools to run easier and last longer
- Pure petroleum combats rust and varnish
- Small package fits anywhere

LUC 10070 | 2oz.



## Gun Oil

- Odorless
- Prevents jamming and overheating
- Resists evaporation
- Penetrates rust and protects from rust, wear and moisture
- Neutralizes acid from fingerprints

LUC 10006 | 2oz.



## Red 'N' Tacky Grease

- Rust and oxidation inhibitors
- Water resistant
- Excellent mechanical stability
- Long storage life
- Agricultural, automotive and industrial applications

LUC 20005-30 | 397g



## Disposable Butane Cylinder

- 5.5 oz. aerosol can
- For use with Bernzomatic butane torches
- Can be used for fueling all leading butane cigarette lighters

ADC BZBF56



## 4+ Furnasafe

- Prevents water from accumulating
- Safely removes water from condensation
- Cleans nozzles & provides hotter flame
- Reduces foaming on tank refills

DSG FS32 | 946ml



## Compressor Oil

Helps promote longer life in all types of reciprocating & rotary compressors. Solvent refined & clay filtered for long lasting, anti-foul operation. Cleans valve seat deposits & extends life.

CRC 75133 | 3.78L



## Heavy-Duty Oil Stabilizer

- 100% petroleum product
- Virtually eliminates dry starts and wear
- Extends oil life
- Lowers oil temperature in any engine, reduces leaking, knocking and blow-by in worn engines
- Helps to control noise, overheating, leaks and wear in gear boxes

LUC 20002 | 3.78L



## Motor Treatment

Sea Foam Motor Treatment is a fuel and oil additive that works to clean and lubricate all types of gas and diesel engines.

SFC SF16 | 16oz  
SFC SF128 | 1 Gallon



## 4+ Premium

Prevents costly fuel pump and injector repairs. A comprehensive multi-purpose fuel enhancer that addresses eight critical fuel performance issues to reduce fuel consumption and extend fuel system, engine and diesel particulate filter life.

DSG FPP16 | 455ml  
DSG FPP32 | 946ml  
DSG FPP4L | 4L



## Diesel Fuel Conditioner

Eliminates varnish and sludge. Reduces corrosion. Prevents stalling and frozen fuel lines. Retards wax formation. Contains anti-gel properties.

KLF 992 | 500ml  
KLF 993 | 1L  
KLF 991 | 150ml Clearance item!



PARTS

AUTOBODY SUPPLY

INDUSTRIAL

REGINA

YORKTON

WEYBURN

ESTEVAN



#### 4+ Diesel Melt

An emergency fast-acting anti-gelling treatment additive that is recommended for fuel that has already gelled.

DSG DM16 | 455ml  
DSG DM32 | 946ml



#### 4+ Polar Max

Super concentrated fuel additive to stop diesel fuel from gelling during winter. Use summer fuel in the winter and save!

DSG PM32 | 946ml



#### 4+ Arctic Plus

A comprehensive multi-purpose winter diesel additive with anti-gel that addresses critical performance issues. It reduces fuel consumption, extends fuel system, engine & diesel particulate filter life.

DSG AP16 | 455ml  
DSG AP32 | 946ml



#### 4+ Turbo Charger Cleaner

Designed for diesel engines to reduce Turbocharger replacement and to maintain performance. All season application to reduce accumulation of carbon, soot, and frees sticking vanes in turbochargers.

DSG FPPTC32 | 946ml



#### Diesel Exhaust Fluid

Air1® Diesel Exhaust Fluid for Selective Catalytic Reduction (SCR) technology in new heavy duty diesel vehicle engines.

REC 55-126AIRX96 | 9.46L



#### Roloc Holder and Discs

A rugged, plastic holder with quick release attachment. 1/4 inch (6 mm) shank works on standard power tool collet systems. Discs sold separately.

MMM 07500 | HOLDER  
MMM 07480 | 2" COARSE DISC  
MMM 07481 | 2" MEDIUM DISC



#### General Purpose 6" x 9" Pads

- Superior alternative to steel wool, wire brushes, sandpaper, and other non-woven products for cleaning or finishing tasks
- Very fine grade aluminum
- Oxide abrasive cleans, finishes, grains, denibs, and defuzzes

MMM 07447



#### Extra Heavy-Duty All Weather Locking Extension Cords

- 12/3 SJEOW
- Outstanding performance in extreme climate conditions at temperatures from -50°C up to +105°C
- Superior resistance to oil, moisture, ozone, cracking, abuse, and wear

ADC LT530825 | 25'  
ADC LT530830 | 50'  
ADC LT530835 | 100'



#### Fire Extinguishers

##### 2.5lb ABC

Automotive dry chemical single use unit with Vehicle Bracket 1A:10BC.

SHD 13315DAUT



##### 10BLB Pro 480

For both common combustible and flammable liquid fires. Fulfills the NFPA's requirements for business use. Comes with metal wall hook 4A:80BC.

SHD 11340R



#### Cut Off Wheels

Multiple sizes available.

PFD 69834 | 3" x 0.045"  
PFD 69817 | 4.5" x 0.030"  
PFD 69818 | 5" x 0.030"



#### CC Grind Disc

- Diameter: 4-1/2"
- Bore: 7/8"
- Max RPM: 13300 RPM
- Compatible mounting flange set: EDP 69116 (5/8-11)

PFD 61200



#### Chop Saw Wheel

- 14" x 3/32"
- 1" AH A 36 K PSF-CHOP
- 4400 RPM

PFD 64492



**Buy more, save more! Case specials on quality anti-freeze available.**

Each case contains 4 3.78L jugs.

**STOCK UP BEFORE WINTER COMES!**

#### Heavy-Duty Diesel Universal Anti-Freeze



REC 16-474

- 50/50 Premix
- Does not require an initial charge of SCA



REC 16-284

- Fully formulated concentrate
- Does not require an initial charge of SCA
- Purple in colour

#### Heavy-duty Extended Life Anti-Freeze



REC 16-324

- 50/50 premix
- Fleet long life anti-freeze
- No need to add water
- Pale yellow in colour



REC 16-314

- Mixed fleet long life anti-freeze concentrate for all engines
- Yellow in colour

**PARTS**

**AUTOBODY SUPPLY**

**INDUSTRIAL**

**REGINA**

**YORKTON**

**WEYBURN**

**ESTEVAN**



## Pry Bars

- Wrecking Bar combines roll head and angle pry bar ends for better access in tight work areas
- Tempered alloy steel
- Electrostatic Powder Coated Finish

ADC TGHT-044-015 | 15"

ADC TGHT-040-024 | 24"

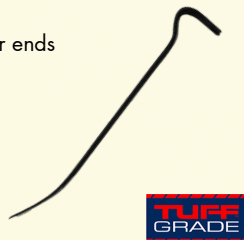

## Screwdrivers

ADC TGSD1101 | #1 Phillips Magnetic Tip  
 ADC TGSD1204 | #2 Phillips Stubby Magnetic Tip  
 ADC TGSD1301 | #3 Phillips Magnetic Tip  
 ADC TGSD3101 | #1 Robertson Stubby Magnetic Tip  
 ADC TGSD3204 | #2 Robertson Stubby Magnetic Tip  
 ADC TGSD3301 | #3 Robertson Magnetic Tip  
 ADC TGSD5101 | 3/16 Slot Magnetic Tip  
 ADC TGSD5204 | 1/4 Slot Stubby Magnetic Tip



## Adjustable Wrenches

- Chrome Vanadium Steel for strength and durability
- Chrome Finish
- Cushioned grip for added comfort and visibility or choose plain grip

ADC IDI-AW6 | 6" Length | 15/16" Jaw Width

ADC IDI-AW10 | 10" Length | 1-5/16" Jaw Width



## Curved Locking Jaw Pliers

- Chrome vanadium steel hardened for maximum strength and durability.
- Bare metal handle
- Curved jaws, knurled tips and wire cutters
- Instantly locks

ADC TGHT-030-007 | 7" | 1.14" max

ADC TGHT-030-010 | 10" | 1.46" max



## 22 Piece Wrench Set

- Chrome vanadium steel alloy for strength and durability
- Polished mirror finish for quick cleaning
- 12 point design minimizes fastener damage and increases torque
- Premium canvas pouch
- 22pc comes in 7mm-32mm Metric
- 16pc comes with 1/4"- 1-1/4"

ADC TGCW-SET-16PC

ADC TGCW-SET-22PC-MET



## M18 Cordless 2-Speed Grease Gun Kit

- 10,000 PSI max operating pressure and 10 oz/Minute flow rate
- Pre-set grease counter dispenses precise amounts
- Air bleeder valve for quick priming
- 2 speed design
- Lock-on/Lock-off trigger
- Run time: up to 10 grease cartridges per charge
- Includes battery, charger and case



MLW 2646-21CT

## Circulating Heater - 8000 Series

- Has a male plug and is made of aluminum.
- CSA-certified
- Has a hose inlet and outlet diameter of 5/8 inches
- 120 volts, 12.5 amps, and 1,500 watts



TEM 330-8003

## Circulating Heaters - 41 Series

- Opens at 190°F and closes at 151°F
- Includes a 5' heavy-duty three-wire attached cord
- Width and height of 8 1/2 inches
- Hose inlet and outlet diameters are 5/8 inches
- 120 volts, 1000W or 1500W, CSA-certified



TEM 220-4029 | 1000W

TEM 220-4037 | 1500W

## Quick Start - Group 75 Dual Terminal Battery

- Affordable power for the value-minded driver
- Ready and reliable for long service life



18-month warranty  
 ISB QS-75DT18

## Quick Start - Group 31 Batteries

- Affordable power for your commercial needs
- Durable design for the long haul



12-month warranty  
 ISB QS-31A12-P8 | Top Post  
 ISB QS-31T12-P8 | Top Stud

## Farm & Ranch Battery Charger/Engine Starter

- 200A (12V) and 150A (6V) Engine Start - Powerful enough for SUVs, trucks, and large engines
- 40A Boost Mode - quickly brings deeply discharged battery back to life
- Scrolling digital display, LED indicators and push-button controls
- Automatically adjusts amperage rate to charge and maintain
- Multi-Stage charging, Auto voltage detection
- Reverse hook-up protection



SCH FR01335

## Jump-N-Carry 12V Jump Starter

The Jump-N-Carry JNC660 1700 Peak Amp 12 Volt Jump Starter is a favorite piece of equipment for automotive service garages, car dealerships, towing operations and busy fleet service facilities.

- 1700 peak ampere
- Battery status indicator gauge
- 46 inch heavy-duty #2 cables
- DC outlet to power 12 volt accessories



G2S SOLJNC660

**Quantities are limited while supplies last.**

**PARTS**

**AUTOBODY SUPPLY**

**INDUSTRIAL**

**REGINA**

**YORKTON**

**WEYBURN**

**ESTEVAN**